

PLANS, PROFILES & SECTIONS
 OF THE
STURGEON CREEK DRAIN OUTLET
 (Geographic Townships of Mersea and Gosfield South)

IN THE
MUNICIPALITY OF LEAMINGTON & TOWN OF KINGSVILLE
 IN THE
COUNTY OF ESSEX • ONTARIO

MUNICIPALITY OF LEAMINGTON
 MAYOR: JOHN PATYSON
 CLEER: SHENIA PERCY
 SPANACE: LUCY-ANN MARCHETTE

Grand Road
 DESIGN: TERRY
**ROAD
 ENGINEERING
 INC.**



DATE: September 28th, 2010

WATERSHED PLAN
 Scale = 1:10,000

- BENCHMARKS:**
- 1) DEEP BENCH MARK IN MANHOLE AT TOWN OF LEAMINGTON POLLUTION CONTROL CENTRE ALONG ERIE CONFERENCE ROAD NO. 20 (SEACIFF BONE EAST) 1.0 KM EAST OF JUNCTION WITH HIGHWAY NO. 16 80.0m NORTH OF CENTRE LINE OF ROAD 20.1m EAST OF FUTURE LINE OF TRUNKWAY, 2.1m EAST OF EAST END OF LARGE CONCRETE SIGN FOR CLIFF. **ELEV = 177.292m**
 - 2) TOP SURB LOCATED AT SOUTHEAST CORNER LANE EASEMENT EAST OF PIPE CHAMBER ON EACH EASEMENT INTERSECTION MERSEA ROAD B **ELEV = 175.550m**
 - 3) TOP MANHOLE LOCATED NORTHWEST OF PROPOSED JUNCTION OF STURGEON CREEK DRAIN AND AUXILIARY OUTLET DRAIN **ELEV = 176.480m**
 - 4) TOP NAIL IN HYDRO POOL LOCATED NORTHWEST OF STURGEON CREEK DRAIN JUNCTION WITH ANDERSON-WEBER DRAIN (IN PARCEL 520-00900) **ELEV = 177.250m**
 - 5) TOP NAIL IN LIGHT SIGNBOARD LOCATED WEST SIDE OF STURGEON CREEK DRAIN ON PARCEL 520-03500 AND NORTHWEST SIDE OF BLOCK 10 **ELEV = 178.660m**

THESE PLANS HAVE BEEN REDUCED TO THIS SCALE AND THEREFORE VARIOUS FULL SCALE PLANS MAY BE VIEWED AT THE MUNICIPAL OFFICE.

DESIGNED BY: G. G. G. ROAD ENGINEERING INC.
 DRAWN BY: TERRY
 CHECKED BY: TERRY
 FILE NO: RE0010047.DWG
 DATE: 09/28/10
 SHEET NO: 1 OF 21

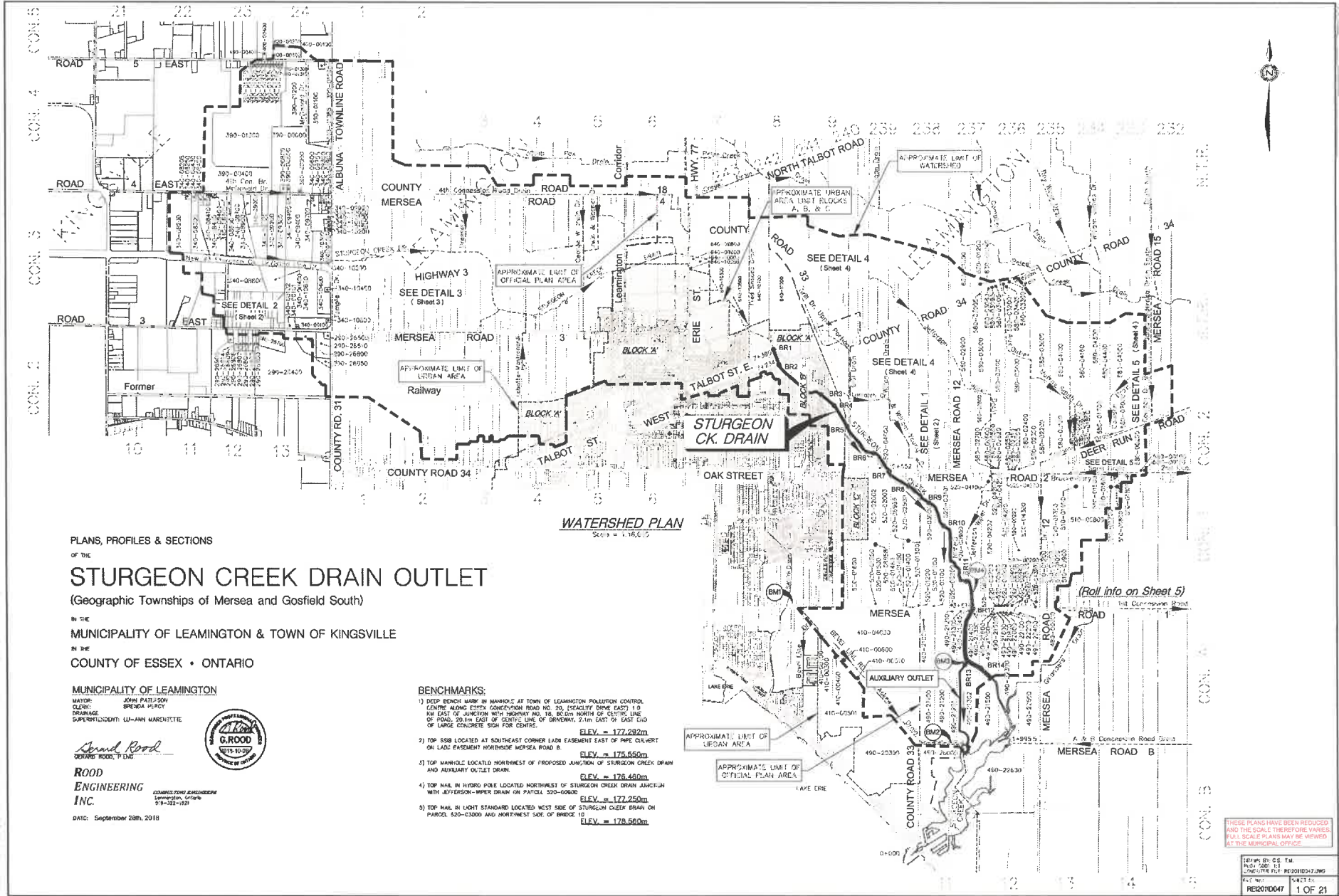

PLANS, PROFILES & SECTIONS
OF THE
STURGEON CREEK DRAIN OUTLET
(Geographic Townships of Mersea and Gosfield South)

IN THE
MUNICIPALITY OF LEAMINGTON & TOWN OF KINGSVILLE
IN THE
COUNTY OF ESSEX • ONTARIO

MUNICIPALITY OF LEAMINGTON

WATOR: JOHN PATRICKSON
ENGINEER
DRAINAGE
SUPERVISOR: LU-ANN MARSHLETTE



**ROOD
ENGINEERING
INC.**

COUNCIL TOWN ENGINEERING
LEAMINGTON, ONTARIO
519-325-1979

DATE: September 20th, 2018

WATERSHED PLAN
Scale = 1:10,000

BENCHMARKS:

- 1) DEEP BENCH MARK IN MANHOLE AT TOWN OF LEAMINGTON POLLUTION CONTROL CENTRE ALONG ESSEX CORRIDOR ROAD NO. 30, EXACTLY 80M EAST 1.9 KM EAST OF JUNCTION WITH HIGHWAY NO. 18, 80 CM NORTH OF CENTRE LINE OF ROAD, 20.1M EAST OF CENTRE LINE OF DRIVEWAY, 7.1M EAST OF EAST END OF LARGE CONCRETE SIGN FOR CENTRE. ELEV. = 177.292m
- 2) TOP SSB LOCATED AT SOUTHEAST CORNER LADE EASEMENT EAST OF PIPE CLAVERT ON LADE EASEMENT HORSESHOE MERSEA ROAD B. ELEV. = 175.550m
- 3) TOP MANHOLE LOCATED NORTHWEST OF PROPOSED JUNCTION OF STURGEON CREEK DRAIN AND AUXILIARY OUTLET DRAIN. ELEV. = 176.480m
- 4) TOP NAIL IN HYDRO POLE LOCATED NORTHWEST OF STURGEON CREEK DRAIN JUNCTION WITH JEFFERSON-HIPPER DRAIN ON PARCEL 520-0000. ELEV. = 177.250m
- 5) TOP NAIL IN LIGHT STANDARD LOCATED WEST SIDE OF STURGEON CREEK DRAIN ON PARCEL 520-0300 AND NORTHWEST SHOT. OF BRIDGE. ELEV. = 178.560m

THESE PLANS HAVE BEEN REDUCED AND THE SCALE THEREFORE VARIES. FULL SCALE PLANS MAY BE VIEWED AT THE MUNICIPAL OFFICE.

Drawn By: G.S. TM
PLT: G.S. TM
Date: 09/18/18
DWG: 1809180247.DWG
File: 1809180247.dwg
RE20180047 1 OF 21